

aune

**BU1** 便携解码耳放  
Portable DAC with Headphone Amplifier

使用手册 / User Manual

# Preface

Dear Customers:

Thanks for purchasing the aune BU1 and congratulations on choosing this high quality fully discrete portable DAC with headphone amplifier.

We sincerely hope the BU1 will bring you excellent Hi-Fi experience.

Please read this user manual carefully before using the device.

# Name and Functions of Each Part

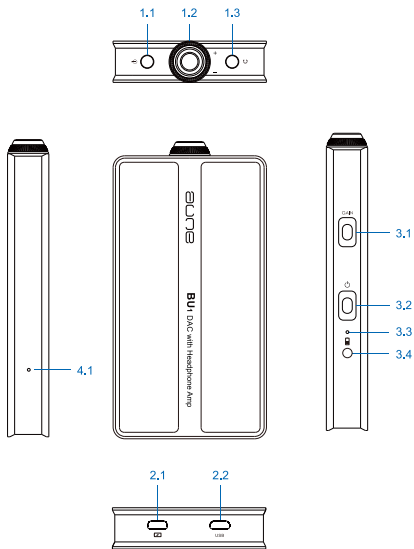

- 1.1 Line output
- 1.2 Volume knob
- 1.3 Headphone port
- 2.1 USB charging port (5V, 1A)
- 2.2 USB DAC input

- 3.1 Gain switch ❶
- 3.2 Power switch ❷
- 3.3 Charging/battery indicator light ❸
- 3.4 Battery life check button ❹

4.1 Reset

## Notes:

- ❶ -: low gain  
+: high gain
- ❷ Up: power on  
Down: power off
- ❸ Press the battery life check button, and the indicator will blink:
  - ○ ○ ● One blink: 10% battery left
  - ○ ● ● Two blinks: 20% battery left
  - ● ● ● Three blinks: 60% battery left
  - ● ● ● Four blinks: 80% battery left
  - ● ● ● Five blinks: full batteryWhen charging, the indicator blinks; when fully charged, the indicator keeps on.
- ❹ When you need to check the battery life, please press the battery life check button.

# Introduction

The BU1 is a fully discrete portable DAC with headphone amplifier that can be connected to a smartphone, a portable music player or a computer via USB to drive a wider range of headphones.

# Specifications

## USB input:

Maximum bit depth: 32bit

Maximum sampling rate: 768k

Maximum DSD rate (native): DSD512

## Line output:

Output level: 2Vrms

THD+N: 0.00076%

SNR: 120dB

## Headphone output:

Output power: 30mW@300Ω

THD+N: 0.0009%

Dimensions: 126mm x 65mm x 18mm

Weight: 230g

Accessories: USB cable, Type C to micro USB cable, quick guide, disk

# Operation Instructions

## Connection with a Smartphone or a Device with USB Output

1. Connect the BU1 and a smartphone/DAP/computer via USB.
2. Connect the BU1's LINE OUT with the LINE IN of a headphone amplifier (like the B1s), or directly plug a pair of headphones into the BU1's headphone port.

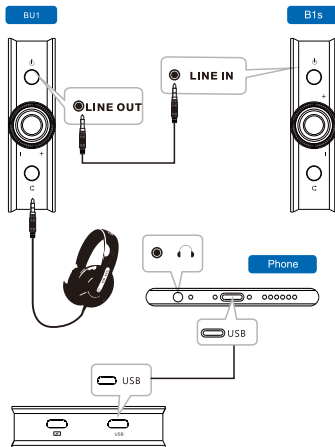

\* Different devices need corresponding cables.

\* The B1s is a pure headphone amplifier that can further improve the driving ability.

aune

**aune | 430034 WUHAN | CHINA**

Email: [sales@auneaudio.com](mailto:sales@auneaudio.com) | Fax: +86 027 85840435 | [www.auneaudio.com](http://www.auneaudio.com)